

Architectural Recessed Lighting



ARCHITECTURAL

**Oak**<sup>TM</sup>

System

1" Miniature LED Downlights



**ELCO Lighting**

*The Best Choice in Lighting*



## The **Architectural Oak™** LED Downlights

Our smallest LED recessed downlights and adjustables are engineered to squeeze into the tiniest of spaces, indoors or outdoors, yet still provide enough power to light up the surroundings. With over 850 lumens delivered, they produce more brilliant white light than a traditional 50W halogen product. The 1" Architectural Oak™ System with push-&-twist connector can be installed into new construction or remodel applications.

# The Architectural Oak™ System

# 1" Miniature LED Downlights



- INTEGRATED LED
- 90+ CRI
- DIMMABLE
- WET LOCATION
- DAMP LOCATION
- IC RATED
- 50,000 HOURS
- 5 YEAR WARRANTY
- TITLE 24 COMPLIANT
- UL LISTED

**DIMS TO WARM**  
SUNSET DIMMING TECHNOLOGY

STYLES	FINISHES	LUMENS	COLOR TEMPERATURE
Round Round Gimbal Round Trimless Square Square Adjustable	White Black Bronze Haze	850 lm to 1000 lm	2700K - 4000K & Sunset

# Oak™ Architectural IC Rated Housings, Frames & Remodel Power Packs

- Compatible with E1AK02 and E1AK12 Downlights
- Listed for direct contact with insulation
- Driver specified for 120V (Triac/ELV dimming) or 120/277V (0-10V/Triac/ELV Dimming)
- Wet Location with wet location light engines
- JA8-2022-E Listed, UL Listed



**E1DWN08AJIC**  
(120V, Triac/ELV)

**E1DWN08AJICDX**  
(120/277V, 0-10V/Triac/ELV)



## Oak™ R60 IC Airtight New Construction Housing

- Double Wall IC Airtight R60 foam insulation and Chicago Plenum housing
- Driver included on frame

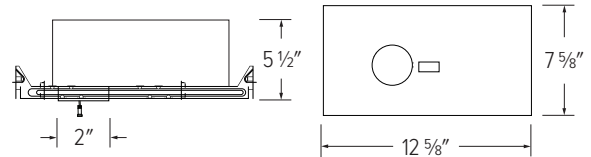

**E1DWN08IC**  
(120V, Triac/ELV)

**E1DWN08ICDX**  
(120/277V, 0-10V/Triac/ELV)



## Oak™ IC New Construction Frame

- IC rated for direct contact with insulation
- Driver included on frame

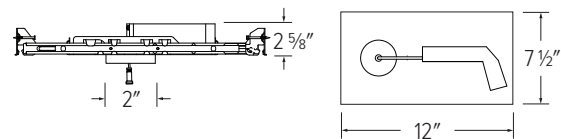

**E1RLA08IC**  
(120V, Triac/ELV)

**E1RLA08ICDX**  
(120/277V, 0-10V/Triac/ELV)



## Oak™ IC Remodel Power Pack

- IC rated for direct contact with insulation
- Fits through 2" hole

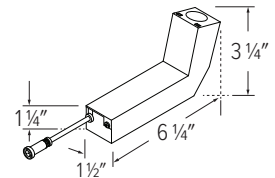

## Accessories for Remodel IC Power Packs

### Oak™ Single Downlight Frames

- Requires power pack
- IC rated



**E1LF1** 2" Cutout - 4 5/8" Sq. frame

### Oak™ Multiple Downlight Frames

- Requires power pack
- IC rated
- For row mounting fixtures



**E1LF1-M2** 2 Set - total length of frame: 8 3/4"  
**E1LF1-M3** 3 Set - total length of frame: 13"  
**E1LF1-M4** 4 Set - total length of frame: 17 1/2"  
**E1LF1-M5** 5 Set - total length of frame: 21 3/4"

# Oak™ Architectural Recessed Downlights

Small aperture downlight delivers up to **1000 lumens**.  
More light than a traditional 50W MR16 Halogen Lamp.

- IC Airtight for use with direct contact with insulation
- Height allows for use in ceilings with under 2" depth
- 38° Standard beam with optional 28° and 50°
- Wet location rated for indoor and outdoor use
- JA8-2022-E, UL Listed
- Life Span 50,000 Hours L70



## 1" Round Downlight

**Lumens:** 850 - 1000 lm  
**Color Temp:** 2700K, 3000K, 3500K, 4000K, Sunset  
**CRI:** 93+  
**Wet Loc:** UL Listed

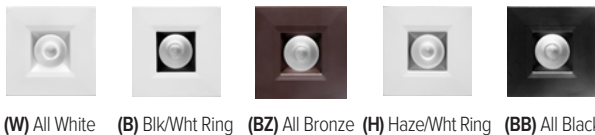
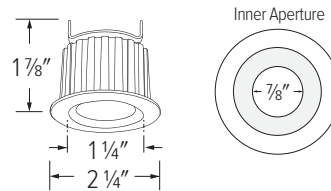

## 1" Square Downlight

**Lumens:** 850 - 1000 lm  
**Color Temp:** 2700K, 3000K, 3500K, 4000K, Sunset  
**CRI:** 93+  
**Wet Loc:** UL Listed

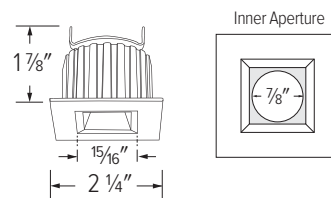

**Product  
Number  
Builder**

1" Oak™ Architectural Downlight	Style	Beam Angle	Color Temperature	Finish
<b>E1AK</b>	<b>02</b> Round <b>12</b> Square	<b>F</b> 38° (Standard) <b>NF</b> 28° <b>WF</b> 50°	<b>27</b> 2700K (850 lm) <b>30</b> 3000K (900 lm) <b>35</b> 3500K (950 lm) <b>40</b> 4000K (1000 lm) <b>SD</b> Sunset (850 lm)	<b>W</b> All White <b>B</b> Black/White Ring <b>BZ</b> All Bronze <b>H</b> Haze/White Ring <b>BB</b> All Black

Example: **E1AK02F40B** [ 1" Oak™ Architectural Round Downlight, 38° Beam Angle, 4000K, Black/White Ring ]



# Oak™ Architectural IC Rated Housings, Frames & Remodel Power Packs

- Compatible with E1AK22 and E1AK32 Adjustables
- Listed for direct contact with insulation
- Frame specified for 900 lumens (8W)
- Driver specified for 120V (Triac/ELV dimming) or 120/277V (0-10V/Triac/ELV Dimming)
- Damp Location Listed
- JA8-2022-E Listed, UL Listed



**E1ATB08AJIC**  
(120V, Triac/ELV)

**E1ATB08AJICDX**  
(120/277V, 0-10V/Triac/ELV)



## Oak™ R60 IC Airtight New Construction Housing

- Double Wall IC Airtight R60 foam insulation housing
- Driver included on frame

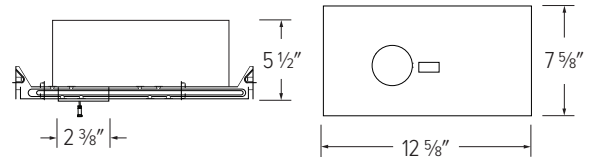

**E1ATB08IC**  
(120V, Triac/ELV)

**E1ATB08ICDX**  
(120/277V, 0-10V/Triac/ELV)



## Oak™ IC New Construction Frame

- IC rated for direct contact with insulation
- Driver included on frame

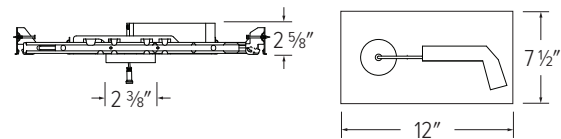

**E1RLA08IC**  
(120V, Triac/ELV)

**E1RLA08ICDX**  
(120/277V, 0-10V/Triac/ELV)



## Oak™ IC Remodel Power Pack

- IC rated for direct contact with insulation
- Fits through 2" hole

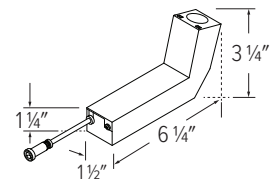

## Accessories for Remodel IC Power Packs

### Oak™ Single Downlight Frames

- Requires power pack
- IC rated



**E1LF2** 2 3/8" Cutout - 4 5/8" Sq. frame

### Oak™ Multiple Downlight Frames

- Requires power pack
- IC rated
- For row mounting fixtures



**E1LF2-M2** 2 Set - total length of frame: 8 3/4"  
**E1LF2-M3** 3 Set - total length of frame: 13"  
**E1LF2-M4** 4 Set - total length of frame: 17 1/2"  
**E1LF2-M5** 5 Set - total length of frame: 21 3/4"

# Oak™ Architectural Recessed Adjustables

Small aperture adjustable downlight delivers up to **900 lumens** with 30° adjustability. More light than a traditional 50W MR16 Halogen Lamp.

- 30° Gimbal adjustability
- IC for use with direct contact with insulation
- Height allows for use in ceilings with under 3" depth
- 38° Standard beam with optional 28° and 50°
- Damp location rated
- JA8-2022-E, UL Listed
- Life Span 50,000 Hours L70



(W) All White



(B) All Black

## 1" Round Gimbal

**Lumens:** 850 - 900 lm  
**Color Temp:** 2700K, 3000K  
**CRI:** 93+  
**Damp Loc:** cUL Listed

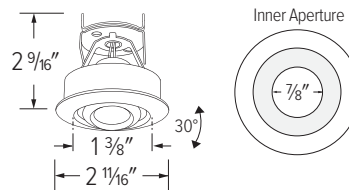

(W) All White



(B) All Black

## 1" Square Pull Down

**Lumens:** 850 - 900 lm  
**Color Temp:** 2700K, 3000K  
**CRI:** 93+  
**Damp Loc:** cUL Listed

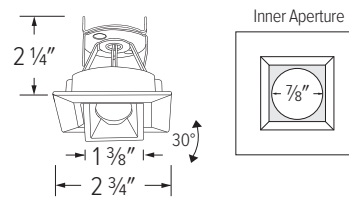

**Product  
Number  
Builder**

1" Oak™ Architectural Adjustables

**E1AK**

Style

**32** Round Gimbal  
**22** Square Pull Down

Beam Angle

**F** 38° (Standard)  
**NF** 28°  
**WF** 50°

Color Temperature

**27** 2700K (850 lm)  
**30** 3000K (900 lm)

Finish

**W** All White  
**B** All Black

Example: **E1AK32F30B** [ 1" Oak™ Architectural Round Gimbal, 38° Beam Angle, 3000K, All Black ]

# Oak™ Architectural IC Rated Housings, Frames & Remodel Power Packs

- Compatible with E1AK61 Trimless Downlights
- Listed for direct contact with insulation
- Frame specified for 900 lumens (8W)
- Driver specified for 120V (Triac/ELV dimming) or 120/277V (0-10V/Triac/ELV Dimming)
- Wet Location with wet location light engines
- JA8-2022-E Listed, UL Listed



**E1TRL08AJIC**  
(120V, Triac/ELV)

**E1TRL08AJICDX**  
(120/277V, 0-10V/Triac/ELV)



## Oak™ R60 IC Airtight New Construction Housing

- Double Wall IC Airtight R60 foam insulation housing
- Driver included on frame

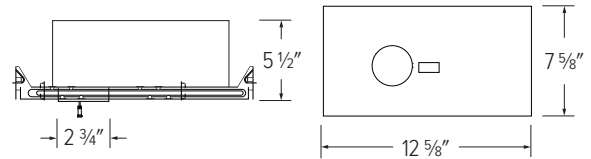

**E1TRL08IC**  
(120V, Triac/ELV)

**E1TRL08ICDX**  
(120/277V, 0-10V/Triac/ELV)



## Oak™ IC New Construction Frame

- IC rated for direct contact with insulation
- Driver included on frame

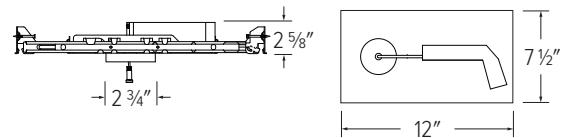

**E1RLA08IC**  
(120V, Triac/ELV)

**E1RLA08ICDX**  
(120/277V, 0-10V/Triac/ELV)



## Oak™ IC Remodel Power Pack

- IC rated for direct contact with insulation
- Fits through 2" hole

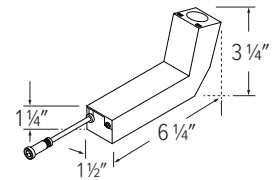

## Accessories for Remodel IC Power Packs

### Oak™ Single Downlight Frames

- Requires power pack
- IC rated



**E2LF1** 2 5/8" Cutout - 4 3/8" L x 4 3/4" W Frame

### Oak™ Multiple Downlight Frames

- Requires power pack
- IC rated
- For row mounting fixtures



**E2LF1-M2** 2 Set - total length of frame: 8 3/4"  
**E2LF1-M3** 3 Set - total length of frame: 13 1/8"  
**E2LF1-M4** 4 Set - total length of frame: 17 1/2"  
**E2LF1-M5** 5 Set - total length of frame: 21 7/8"



# Oak™ Architectural Trimless Downlights

Small aperture downlight delivers up to **1000 lumens**.  
More light than a traditional 50W MR16 Halogen Lamp.

- Trimless Downlight Requires: 1" Trimless LED Light Engine (E1AK61F Series) plus 1" Trimless Spackle Frame (EL01SFR) sold separately
- IC Airtight for use with direct contact with insulation
- Height allows for use in ceilings with under 3" depth
- 38° Standard beam with optional 28° and 50°
- JA8-2022-E, UL Listed

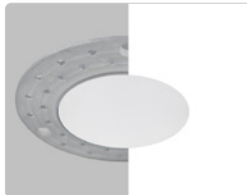

## Spackle Frame

Well engineered extra thin spackle frame for a easy mudding and lasting quality



## Oak™ Trimless Design

Designed to seamlessly make the trim ring invisible showing only the reflector and lens

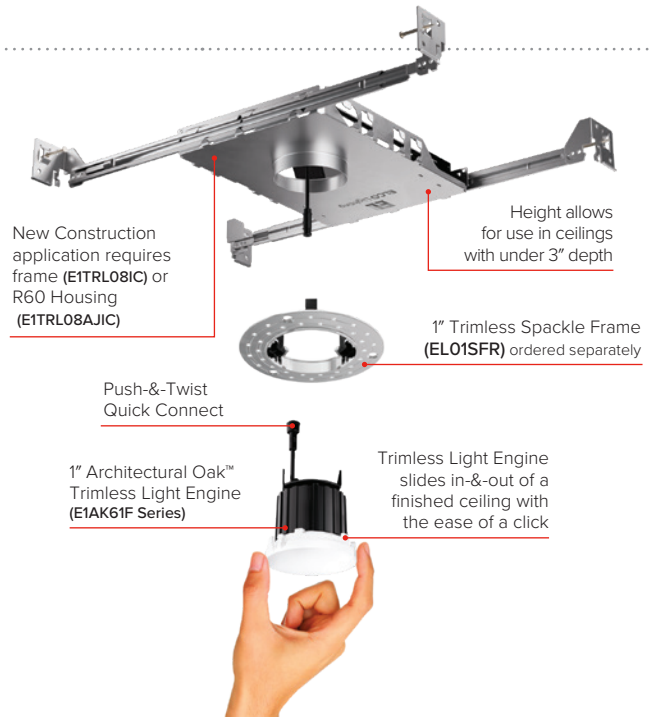

## 1" Round Trimless

**Lumens:** 850 - 1000 lm  
**Color Temp:** 2700K, 3000K, 3500K, 4000K, Sunset  
**CRI:** 93+  
**Wet Loc:** UL Listed

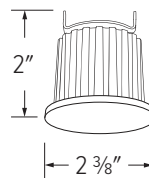

## 1" Trimless Spackle Frame

**EL01SFR** 2 3/8" I.D. - 4" O.D.



(W) All White

(B) All Black

(BZ) All Bronze

**Product  
Number  
Builder**

1" Oak™ Architectural Trimless	Style	Beam Angle	Color Temperature	Finish
<b>E1AK</b>	<b>61</b> Round	<b>F</b> 38° (Standard) <b>NF</b> 28° <b>WF</b> 50°	<b>27</b> 2700K (850 lm) <b>30</b> 3000K (900 lm) <b>35</b> 3500K (950 lm) <b>40</b> 4000K (1000 lm) <b>SD</b> Sunset (850 lm)	<b>W</b> All White <b>BB</b> All Black <b>BZ</b> All Bronze

Example: **E1AK61FSDW** [ 1" Oak™ Architectural Round Trimless, 38° Beam Angle, Sunset, All White ]

# Oak™ Architectural Accessories

## Trims (for use with E1AK02 and E1AK12 only)



**RM1W** All White    **RM1B** Black/Wht Ring    **RM1BZ** All Bronze    **RM1H** Haze/Wht Ring    **RM1BB** All Black



**RM11W** All White    **RM11B** Black/Wht Ring    **RM11BZ** All Bronze    **RM11H** Haze/Wht Ring    **RM11BB** All Black

## Trimless Ring (for use with E1AK61 only)



**RM1TLW** All White    **RM1TLB** Black/Wht Ring    **RM1TLBZ** All Bronze

## Lens & Optics (field changeable for E1AK02, E1AK12 & E1AK32)



Optional Lens  
**EP713C** (28°)  
**EP714C** (38°)  
**EP715C** (50°)



Frosted Diffuser  
**L60**  
 For a softer light

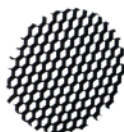

Hex Louver  
**L61**  
 For a better glare shield

## Fire Rated Products

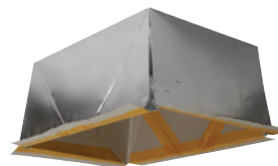

1-Hour Fire Enclosure for Recessed Fixtures

**FIREENCL** Standard - 9" H x 20 3/8" L x 14 3/8" W  
**FIREENCL-S** Shallow - 7 1/4" H x 16" L x 14 3/8" W

Provides fire barrier around recessed lights. ETL approved 1-hour fire rating. Meets UL 263, ASTM E119 Specifications. To be used with Mica Tape (FIRETAPE sold separately) to seal the power feeding point.



Mica Adhesive Fire Tape for Fire Enclosure

**FIRETAPE** 3/4" W x 16' L

Fire proof mica adhesive tape helps seal the power feeding point on Fire Enclosure. Offers outstanding high temperature and flame resistance, and provides excellent electrical insulation.



2-Hour Fire Cover for Recessed Fixtures

**FIRECVR** 9 3/4" H x 17" O.D. x 13" I.D.

Made of heat activated intumescent material. UL approved for most ceiling types: sheetrock drywall, gypsum & acoustical tiles. UL Rated enclosure stops flame spread and heat transmission for up to 2 hours.

# Photometric Report

## Oak™ Architectural LED Light Engines

### PHOTOMETRIC REPORT

Product #: E1AK02F40  
 Wattage / Lumens: 8.1W / 1012 lm  
 Luminaire LPW: 124.9 lm/W

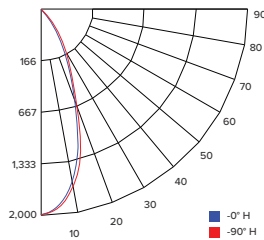

### CANDLE POWER SUMMARY

Degress Vertical	0°
0	1978
5	1867
15	1303
25	537
35	197
45	48
55	20
65	11
75	7
85	1
90	0

### ILLUMINANCE AT A DISTANCE

Distance to Target Plane	Center Beam Footcandles	Beam Diameter
4'	124	2.8'
6'	54.9	4.1'
8'	30.9	5.5'
10'	19.8	6.9'

### ZONAL LUMEN SUMMARY

Zone	Lumens	%Luminaire
0-30°	793.7	79.3
0-40°	922.5	92.2
0-60°	982.0	98.1
0-90°	1,000.8	100

### PHOTOMETRIC REPORT

Product #: E1AK12F27  
 Wattage / Lumens: 8W / 853 lm  
 Luminaire LPW: 106.6 lm/W

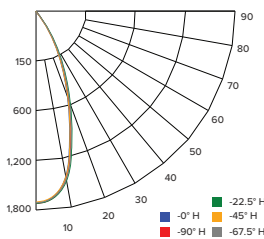

### CANDLE POWER SUMMARY

Degress Vertical	0°
0	1707
5	1661
15	1138
25	433
35	125
45	42
55	24
65	14
75	6
85	1
90	0

### ILLUMINANCE AT A DISTANCE

Distance to Target Plane	Center Beam Footcandles	Beam Diameter
4'	107	2.7'
6'	47.4	4.0'
8'	26.7	5.4'
10'	17.1	6.7'

### ZONAL LUMEN SUMMARY

Zone	Lumens	%Luminaire
0-30°	678.5	79.8
0-40°	767.3	90.3
0-60°	827.6	97.3
0-90°	850.1	100

### PHOTOMETRIC REPORT

Product #: E1AK22F30  
 Wattage / Lumens: 8.1W / 897 lm  
 Luminaire LPW: 110.7 lm/W

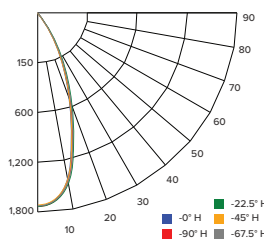

### CANDLE POWER SUMMARY

Degress Vertical	0°
0	1756
5	1698
15	1173
25	497
35	146
45	52
55	18
65	8
75	4
85	0
90	0

### ILLUMINANCE AT A DISTANCE

Distance to Target Plane	Center Beam Footcandles	Beam Diameter
4'	110	2.8'
6'	48.8	4.2'
8'	27.4	5.6'
10'	17.6	7.0'

### ZONAL LUMEN SUMMARY

Zone	Lumens	%Luminaire
0-30°	714.4	79.8
0-40°	820.3	91.7
0-60°	881.3	98.5
0-90°	894.8	100

### PHOTOMETRIC REPORT

Product #: E1AK32FSD  
 Wattage / Lumens: 8.1W / 850 lm  
 Luminaire LPW: 104.9 lm/W

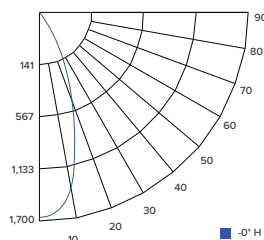

### CANDLE POWER SUMMARY

Degress Vertical	0°
0	1675
5	1620
15	1126
25	486
35	135
45	42
55	18
65	10
75	5
85	1
90	0

### ILLUMINANCE AT A DISTANCE

Distance to Target Plane	Center Beam Footcandles	Beam Diameter
4'	105	2.8'
6'	46.5	4.2'
8'	26.2	5.6'
10'	16.7	6.9'

### ZONAL LUMEN SUMMARY

Zone	Lumens	%Luminaire
0-30°	678.6	81.2
0-40°	768.6	91.9
0-60°	818.9	98
0-90°	836.0	100

ELCAT1069

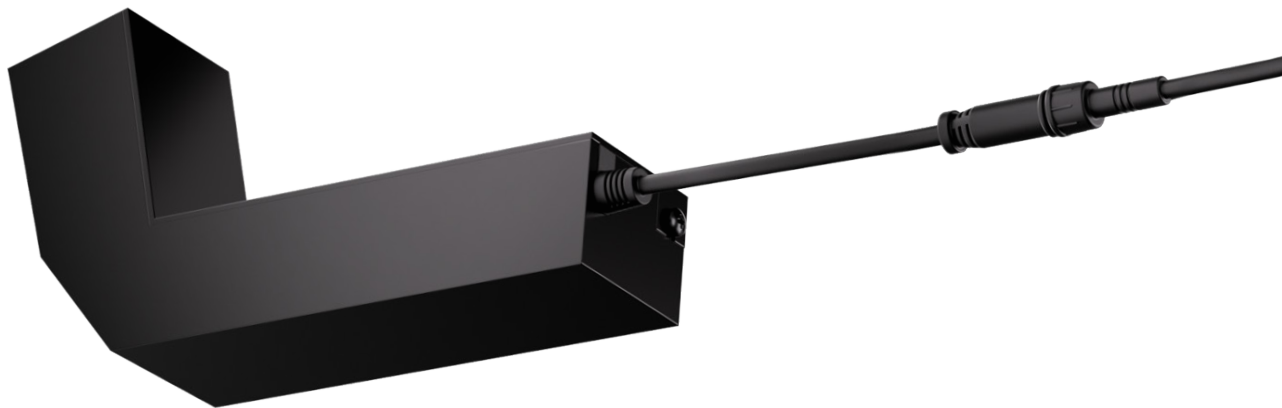

**EL** ELCO Lighting

**Corporate Headquarters**

2042 E. Vernon Ave.  
Vernon, CA 90058  
Tel: 323.231.2600  
Fax: 323.231.3200  
elcolighting.com

**Customer Service**

Tel: 800.522.2626  
Fax: 800.644.2626  
orderdesk@elcolighting.com  
customerservice@elcolighting.com  
sales@elcolighting.com

Printed in the U.S.A.  
\$8.00

09/24

© ELCO Lighting. The marks appearing in this catalog are registered trademarks of ELCO Lighting. Other marks used herein are recognized trademarks of their respective companies. Products shown in this brochure may be covered by U.S. and international patents. Specifications subject to change without notice.