

Introducing the all New **2" Koto Sylo™**

Monopoint, Track Head, Pendant, & Surface Mount with Koto™ LED Module

A solution for every space: **Surface, Monopoint, Pendant & Track Head** styles with all the power from our 2" Aperture **Koto™ Module**.

Explore all the possibilities that come from the features offered by The Koto™ Module with these different mounting options.

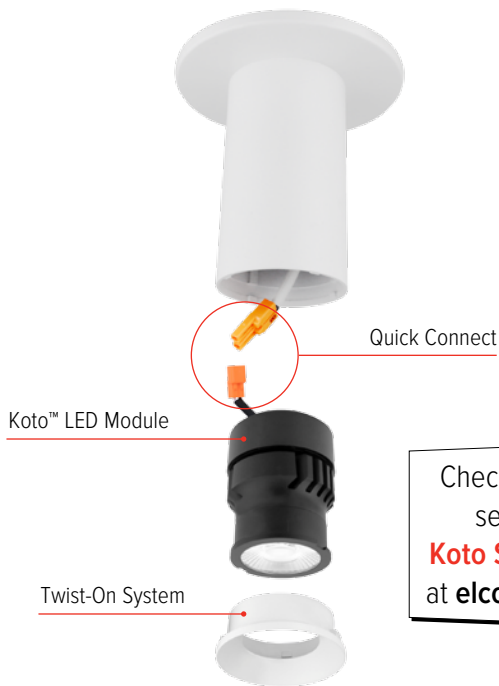

Covered by U.S. PATENTS and Patents Pending

Koto Sylo™ LED Fixtures



- Includes: Standard 38° lens installed with 28° & 60° lenses in box. Optional 15° & 18° lenses available.
- Sunset option dims from 3000K to 1800K.

Sylo™ LED Monopoint

E25M

Fits 3 1/2" and 4" Octagon and Round Junction Boxes. 90° tilt, 358° rotation.



Sylo™ LED Track Head

E25T

Works with single and two circuit track. 90° tilt, 358° rotation.

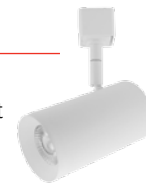

Sylo™ LED Pendant

E25P

Fits 3 1/2" and 4" Octagon and Round Junction Boxes.



Sylo™ LED Surface Mount

E25F

Fits 3 1/2" and 4" Octagon and Round Junction Boxes.



	Koto Sylo™	Finish	Koto™ Module	Color Temperature	Beam Angle
Product Number	E25M Monopoint	W All White	-07 750 lm	27 2700K	(Blank) 38° lens
Builder	E25T Track	B All Black	-09 950 lm	30 3000K	-S 18° lens
Koto Sylo™	E25P Pendant	S All Silver	-11 1150 lm	35 3500K	-N 28° lens
	E25F Surface Mount			40 4000K	-W 60° lens
				SD Sunset	-FC 18° - 50°
					(07 Module Only)
			-08 825 lm	CT5 2700K - 5000K	
			-10 1000 lm		

Example: **E25MW0735-FC** [Koto Sylo™ Monopoint, All White, Koto™ LED Standard Module 750 lumens, 3500K, Focus Beam Angle]

Subject to US tariffs. All other standards, terms and conditions apply.
 Please provide your e-mail address to salesadmin@elcolighting.com. To unsubscribe e-mail: salesadmin@elcolighting.com



E-mail your order to: orderdesk@elcolighting.com
 Tel: **800.522.2626** • Fax: **800.644.2626**

