

4" Trimless Cedar System New Construction IC Airtight Housing w/Driver

IC Airtight housing for trimless, high-end residential and light commercial, 850-1600 lumens.

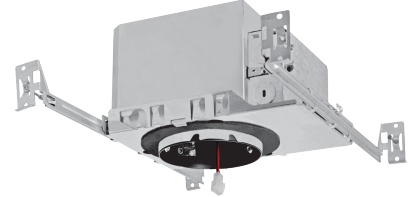

Features

- cUL Listed for direct contact with insulation.
- Compatible with 2 x 8 construction.
- Optional 90 minutes, 120/277 VAC, 60Hz, Emergency Backup.
- Flicker-Free Dimming.
- USA designed and assembled.
- Limited 5 year warranty.
- For use with ELCO Cedar™ System 4" Trimless LED Light Engines.
- 2 at the end of the item number denotes Generation 2. Please note Gen 2 and Gen 1 are not cross compatible.

Specifications

| | |
|----------------------|-----------------|
| Wattage | 19 MAXW |
| Dimmable | Triac/ELV/0-10V |
| Power Factor | ≥0.95 |
| Damp Location | Listed |

E4TL08ICA Dimensions

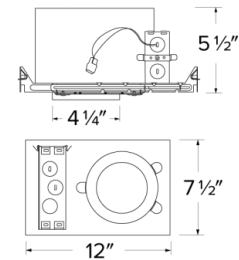

E4TL16ICA Dimensions

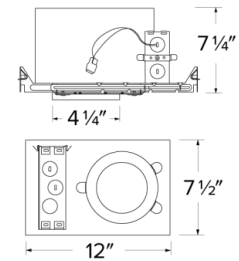

Technical Details

Construction:

- For use in IC and non-IC conditions. Up to 1600 lumens.
- Housing adjusts in frame to accommodate up to 1 1/2" ceiling thickness.
- Airtight housing with gasket to restrict airflow in accordance with ASTM E-283 air-tight requirements.

Installation:

- Designed for ceiling plenums where 2x6 joists or taller are used.
- High strength hanger bars can easily be nailed to joists.
- Suitable for T-grid and drop ceiling applications.
- See installation sheet for detailed information.

Junction Box: Positioned to accommodate straight conduit runs. Two 3/4" knockouts, Seven 1/2" trade size conduit knockouts, One 3/8" knockout. Four Pry-out knockout slots for easy romex installation.

Hanger Bars: Pre Installed hanger bars with True Nail easy installation in regular lumber, engineered lumber, and Laminated Beams. Integral T-bar slots for easy installation in T-Bars. Spans up 24" and can be repositioned 90°. Score lines allow for tool-free hanger bar size reduction. Integral leveling flange allows for single-person installation while easily aligning the housings with the joists.

Electrical:

- Driver is rated for 120V and 277V input (120/277V).
- High Efficiency driver with a power factor > 0.95.

Emergency Battery Pack: Optional 90 minute battery pack available with test indicator switch. Note that double wall housings require Access From Above Ceiling for Battery Maintenance.

Dimmability:

- 3 in 1 dimming: Triac, ELV and 0-10V dimming in one driver.
- 0-10V dimming down to 5% with a compatible dimmer.
- Can be specified with Lutron drivers for 0.1% and 1% dimming.
- For a full list of dimmers refer to the Dimmer Compatibility List.

Listings: cUL Listed for Damp Location and for Wet Location with select trims. cUL Listed for Direct Contact with Insulation and Combustible Material. cUL Listed for Feed Through.

Product Number

| Item | Description | Watts | Dimming |
|-----------------------|--------------------------|--------|-----------------|
| E4TL12ICAD2EM7 | Emergency Battery Backup | 19 MAX | Triac/ELV/0-10V |

Product Number Builder

Example: E4TL08ICA2

| | | | | | |
|-----------------------------------|------------------------------------|-------------|--|------------------|---|
| ELCO Cedar 4" Trimless Housing | Lumens | IC Airtight | Dimming | Generation | Optional |
| E4TL | | | | | |
| | 08 850 lm 12 1250 lm 16 1600 | ICA ICA | 120V Triac/ELV D Triac/ELV/0-10V SD Sunset L Lutron | 2 Gen 2 Gen 1 | No EM EM1 Emer. Backup up to 700 lm EM2 Emer. Backup to 1100 lm EM7 Emer. Backup 15W MAX |

Compatible Products

For use with 4" Cedar™ Trimless IC LED housings with Driver



4" Cedar™ Trimless LED Light Engines



Round Reflector Trim

E430C

Finishes:
(W, B, BZ)



Round Baffle Trim

E434C

Finishes:
(W, B, BZ)

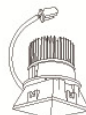

Square Reflector Trim

E444C

Finishes:
(W, B, BZ)

PRODUCT NUMBER BUILDER

| 4" Cedar™ Trimless | Style | Lumen | Color Temperature | Finish |
|--------------------|-----------------------------|--------------------------------|--------------------------|----------------------|
| E4 | | | | |
| | 30C Round Reflector | 08 850 lm | 27 2700K | W All White |
| | 34C Round Baffle | 12 1250 lm (Round only) | 30 3000K | B All Black |
| | 44C Square Reflector | 16 1600 lm (Round only) | 35 3500K | BZ All Bronze |
| | | | 40 4000K | |
| | | | 50 5000K | |
| | | | SD Sunset Dimming | |

4" Cedar™ Trimless Accessories



Fire Cover

| CAT NO. | SPECIFICATIONS |
|---------|---------------------|
| FIRECVR | 9 3/4" H x 17" O.D. |



Fire Enclosure

| CAT NO. | SPECIFICATIONS |
|------------|-------------------------------|
| FIREENCL | 20 3/8" L x 14 3/8" W |
| FIREENCL-S | Shallow, 16" L x 14 3/8" W |



Mica Fire Tape

| CAT NO. | SPECIFICATIONS |
|----------|----------------|
| FIRETAPE | 3/4" W x 16' L |