

# 2" Koto™ Architectural

## Maximum Adjustability High Lumen IC Airtight Housing

Koto™ Architectural Housing: 120/277V (0-10V/Triac/ELV) or 120V (Triac/ELV), and ICALWN (Lutron Athena Wireless Node) with optional Emergency Battery Backup. Must be used with Koto™ Architectural LED Light Engines (ELK21 and ELK24 Series). Lumen output based on module.



### Features

- IC Airtight for direct contact with insulation.
- Easy-to-Remove driver.
- MAX. 35° adjustability.
- Optional 90 minutes, 120/277 VAC, 60Hz, Emergency Backup.
- Flicker-Free Dimming.
- USA designed and assembled.
- Limited 5 year warranty.
- For use with ELCO Koto™ Architectural LED Light Engines (ELK21 and ELK24 Series).

### Specifications

Wattage	18.9W
Lumens	1500 lm
Voltage	120/277V
Dimmable	0-10V/Triac/ELV (1% Dimming)
Lamp Type	LED
Power Factor	≥0.95
Damp Location	Listed

### Dimensions

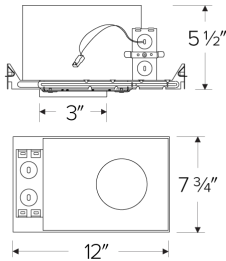

### Technical Details

**Construction:** Double Wall IC Rated for direct contact with insulation. For use in IC and Non-IC conditions. Up to 1500 lumens. Housing accommodates up to 3/8" ceiling thickness. Airtight housing with gasket to restrict airflow in accordance with ASTM E-283 air-tight requirements.

**Installation:** Designed for ceiling plenums where 2x6 joists or taller are used. High strength hanger bars can easily be nailed to joists. Suitable for T-grid and drop ceiling applications. See installation sheet for detailed information. Emergency Battery Back-up Option requires access from above. For use with ELCO Koto™ Architectural LED Light Engines (ELK21 and ELK24 Series).

**Junction Box:** Positioned to accommodate straight conduit runs. Two 3/4" knockouts, Seven 1/2" trade size conduit knockouts, One 3/8" knockout. Four Pry-out knockout slots for easy romex installation.

**Hanger Bars:** Pre Installed hanger bars with True Nail easy installation in regular lumber, engineered lumber, and Laminated Beams. Integral T-bar slots for easy installation in T-Bars. Spans up 24" and can be repositioned 90°. Score lines allow for tool-free hanger bar size reduction. Integral leveling flange allows for single-person installation while easily aligning the housings with the joists.

**Electrical:** Driver is rated for 120V and 277V input (120/277V). High Efficiency driver with a power factor > 0.95.

**Emergency Battery Pack:** Optional 90 minute battery pack available with test indicator switch. Note that double wall housings require Access From Above Ceiling for Battery Maintenance.

**Dimmability:** 3-in-1 Dimming: Triac, ELV and 0-10V dimming in one driver. 0-10V Dimming down to 1% with a compatible dimmer. ICALWN - Lutron Athena Wireless Node. Can be specified with Lutron drivers for 0.1% and 1% dimming. For a full list of dimmers refer to the Dimmer Compatibility List.

**Listings:** cUL Listed for Damp Location and for Wet Location with select trims. cUL Listed for Direct Contact with Insulation and Combustible Material. cUL Listed for Feed Through.

### Product Number

Item	Description	Lamp type	Lumens	Watts	Voltage	Dimming
E2LK95ICAD	High Lumen Maximum Adjustability Housing	LED	1500 lm	18.9W	120/277V	0-10V/Triac/ELV (1% Dimming)

Product Number Builder

Example: E2LK41ICA

Koto™ Architectural High Lumen Housing	Voltage (Wattage)	Dimming
E2LK	<div><div>41</div>120V (15.7W)<sup>1</sup></div> <div><div>42</div>120/277V (15.7W)<sup>2</sup></div> <div><div>94</div>120V (18.9W)<sup>1</sup></div> <div><div>95</div>120/277V (18.9W)<sup>2</sup></div>	<div><div>ICA</div>Triac/ELV</div> <div><div>ICAD</div>0-10V/Triac/ELV<sup>3</sup></div> <div><div>ICALWN</div>Lutron Athena Wireless</div>

<sup>1</sup> Available as 120V, Triac/ELV only

<sup>2</sup> Available as 120/277V, 0-10V/Triac/ELV only

<sup>3</sup> 1% Dimming

# Compatible Products

For use with Dedicated 2" Koto Architectural ICA LED Housings



## Koto™ Architectural LED Light Engine

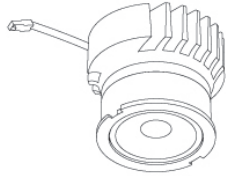

Koto™ LED Light Engine  
ELK21 & ELK24

PRODUCT NUMBER BUILDER				
Koto™ LED Light Engine	Lumens	Color Temperature	Beam Angle	
ELK				
	21 1100 - 1500 lm*	27D 2700K	(blank)	38° lens (Standard)
	24 1100 - 1800 lm*	30D 3000K	-S	18° lens
		35D 3500K	-N	25° lens
		40D 4000K	-W	60° lens
			-FC	18° - 50° Adjustable (ELK21 Only)

\*Wattage based on housing.

### ACCESSORIES



#### Lens

EP731C 18° Lens  
EP732C 25° Lens  
EP733C 38° Lens  
EP734C 60° Lens

\*EP732C, EP733C, EP734C Included



#### Snoot

L50W White  
L50B Black



#### Secondary Optics

L45 Hex Louver  
L46 Linear Lens  
L47 Spread Louver  
L49 Frosted Lens  
L51 Color Shifter

## 2" Pex™ Twist-On Trims



Round Deep  
Reflector

ELK2818

Finishes:  
(W, B, H, BB, BZ)



Round Adjustable  
Reflector

ELK2829

Finishes:  
(W, B, H, BB, BZ)



Round Adjustable  
Pinhole

ELK2827

Finishes:  
(W, B, BB, BZ)



Square Deep  
Reflector

ELK2518

Finishes:  
(W, B, BB)



Square Adjustable  
Reflector

ELK2529

Finishes:  
(W, B, BB)



Square  
Reflector

ELK2541

Finishes:  
(W, B, BB)



Square Adjustable  
Pinhole

ELK2527

Finishes:  
(W, B, BB)



Round  
Gimbal

ELK2888

Finishes:  
(W, B, BZ)



Square Gimbal

ELK2588

Finishes:  
(W, BZ)

## 2" Pex™ Trimless

Only for use with E2LK41ICA, E2LK42ICAD, E2LK94ICA & E2LK95ICAD Housings



Spackle Frame

EL2SFR



Adjustable Trimless Reflector

ELK215

Finishes:  
(W, B)

\*Finishes: **W** - All White, **BB** - All Black, **BZ** - All Bronze,  
**B** - Black Reflector w/White Ring, **H** - Haze Reflector w/White Ring